

Twister

Electro-mechanical turnstile

Functional and practical passage selection.

Twister is Came's new turnstile for transit selection in areas with high-flow volumes. Made of stainless steel it is ideal for train stations and ports, underground stations, sports centres and any setting that requires selection of people-transit flows to optimise entry and exit operations. Twister also seamlessly integrates with Came's access control systems.



The body.
Entirely made of AISI 304 INOX steel with a "scotch-brite" finish, it is fitted with a removable upper panel featuring a key lock.



The internal mechanism.
It is fitted with a "hydraulic damper", control logic and automatic tripod release in case of power outages.



Built-in traffic light.
There is a built-in traffic light on the top of the Twister structure. The two arrows show the passing direction. Access can be controlled by selecting a function on the control panel, for passage with a badge or by command for just authorised people.



Advantages of Twister

Twister is Came's study and functional solution to all your transit control and selection needs. It can be installed anywhere, in high-volume flow sites such as stadiums, terminals, underground stations, public buildings and sports centres. It's controlled by a built-in, control board. Twister is perfectly compatible with Came's RBM84 state-of-the-art access control systems. The practical display on the top of the structure can be used as an electronic meter or a clock.

Dimensions

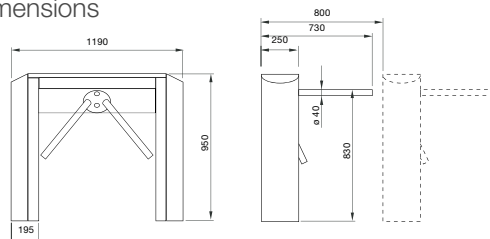

Dimensions in millimeters (25,4 mm = 1 in)

Ideal for access control

Twister can be perfectly integrated with the RBM84 access control system, to obtain real control of transit flows into and out of the areas where it is employed.

Technical features

Type	PSBPS07
Power supply (V)	24V D.C.
Protection rating (IP)	44
Current draw (mA)	233
Weight (Kg)	60
Operating temperature (°C/°F)	-20 ÷ +55 / -4 ÷ +131
120V A.C. - 60 Hz PRODUCTS, PLEASE CHECK OUR PRICE LIST	

● 24V D.C.



The complete range

Electromechanical tripod turnstile

- Parking systems and access control price list -



001PSBPS07 24V D.C. bidirectional mechanical turnstile made of AISI 304 stainless steel with scotch-brite finish, complete with control board and hydraulic damper. Automatic tripod release in case of blackouts.

Additional accessories for electromechanical tripod turnstiles.



001PSOPSC01 Antipanic rods with pressure joints.



001PSOPGO1 AISI 304 steel channeler - H 100cm complete with metal flange riser and plastic flange cover.

001PSOPGO1X AISI 304 steel channeler - H 100 cm complete with metal flange riser and plastic flange cover.



001PSCSCR04 Remote control console for up to 4 through-ways.

Complementary accessories for electromechanical tripod turnstiles.



001OPSCBP Overclimbing system with detection sensors and alarm and cover pressure detection sensor.

001PSPEBUL Ramp with anticorodal outer structure and brown aluminium plate stepping deck. For matching with Top barriers.

NOTES:

To couple with access control systems see RBM84 on p. 208